



Balloon Federation of America
Young Guns, 2024
 Longview, Texas

Task Data Sheet

Flight: 2
 Tasks #5, #6, #7, #8, #9

Launch area:	Individual launch	Sunrise/Sunset:	6:11:00 AM	15-Jun-2024
Launch period:	Opens at 06:11	Min. ILP → all goals:	1km	
PZs in force:	all active	Next briefing:	5:30	
Solo flight:	not required	QNH	1013	

Task:	5 FIN Fly In (Rule 15.4)	Task order:	in order
a. Position of set goal/target	3495 3439 / 9599	MMA:	Lesser 100m or Conf. of Fid
Scoring period: ends at 07:45	Scoring Method	Marker Color:	Red
Scoring area: Entire Contest Area	2D/3D	Marker Drop:	Gravity
		Loggermark #:	1

Task:	6 FON Fly On (Rule 15.5)	Task order:	in order
a. Method of declaration (also see Section II.12 and 12.3)	Logger Goal ONE		
b. Number of goals permitted	1		
c. Goals available for declaration	Published list or 4x4 coordinate with altitude.		
d. Declaration point requirement	Minimum goal altitude 900' msl		
e. Minimum and maximum distance between declaration point and declared goal(s)	None	MMA:	N/A
f. Minimum and maximum distances of declared goal(s) from any other targets noted on TDS.	1k min, no Max	Marker Color:	N/A
Scoring period: ends at 08:15	1k min, no Max	Marker Drop:	N/A
Scoring area: Entire Contest Area	Scoring Method	Loggermark #:	2
	3D		

Task:	7 GBM Gordon Bennett Memorial (Rule 15.8)	BILL BUSSEY TASK	Task order:	in order
a. Position of goal/target	3299 3226 / 9945			
b. Description of scoring area(s)	Inside Race Car - See Sketch (Inside paper perimeter is IN)			
Scoring period: ends at 08:30	Scoring Method	MMA:	See Sketch	
Scoring area: See Sketch	Limited Area	Marker Color:	Dark Blue	
		Marker Drop:	Free	
		Loggermark #:	N/A	

Task:	8 HWZ Hesitation waltz (Rule 15.3)	Task order:	in order
a. Position of various set goals/targets	3052 / 0204 (near 3002)		
	3102 3169 / 0271		
	3103 / 0389		
Scoring period: ends at 08:45	Scoring Method	MMA:	Lesser 50m or Conf. of Fid
Scoring area: Entire Contest Area	2D/3D	Marker Color:	Yellow
		Marker Drop:	Free
		Loggermark #:	3

Task:	9 XDD Maximum Distance Double Drop (Rule 15.18)	Task order:	in order
a. Description of scoring area(s)	See Sketch		
	2 Logger marks within scoring area		
Scoring period: ends at 09:00	Scoring Method	MMA:	N/A
Scoring area: See Sketch	2D	Marker Color:	N/A
		Marker Drop:	N/A
		Loggermark #:	4, 5

3299
+

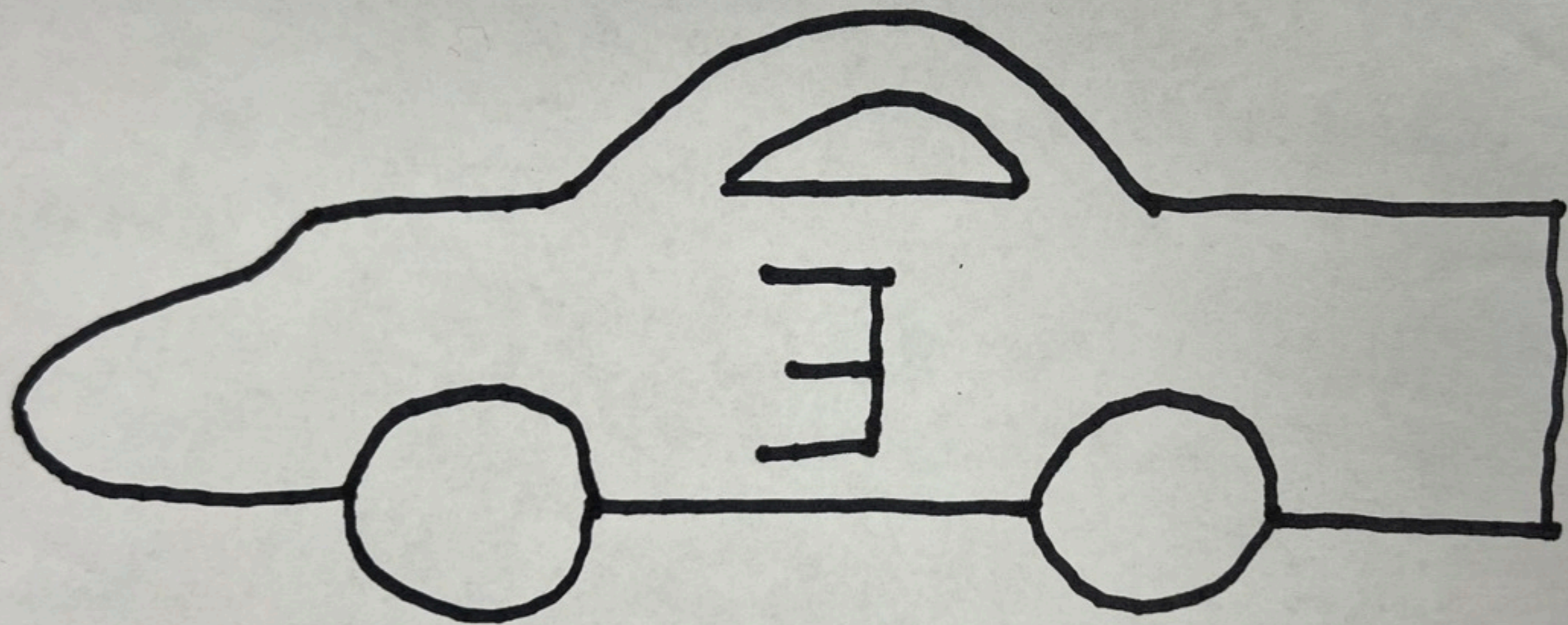

335°
↙

100'

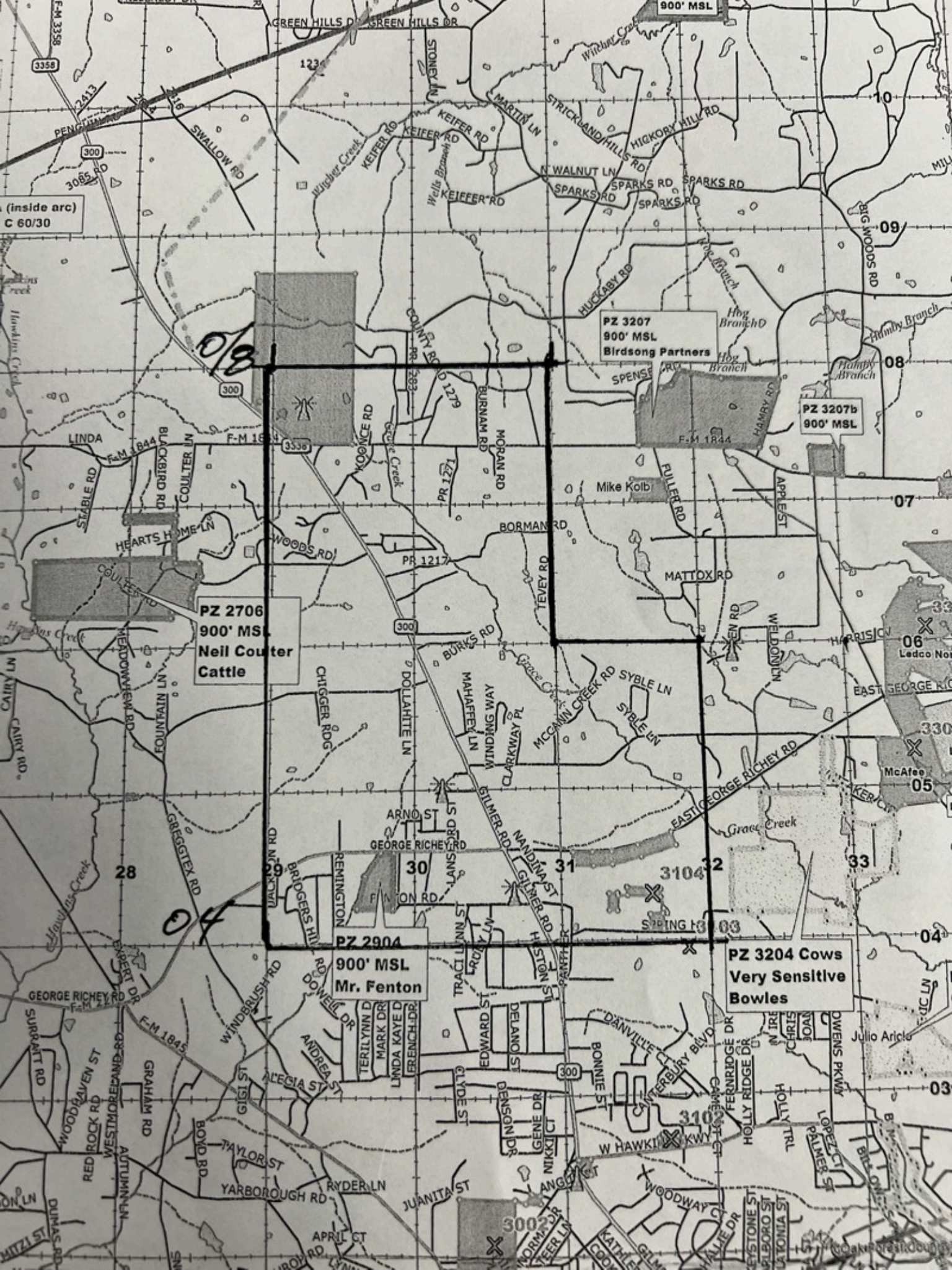

(inside arc)
C 60/30

900' MSL

018

PZ 2706
900' MSL
Neil Couter
Cattle

PZ 3207
900' MSL
Birdsong Partners

PZ 3207b
900' MSL

PZ 2904
900' MSL
Mr. Fenton

PZ 3204 Cows
Very Sensitive
Bowles

3000' MSL